

TOOLS

10 pc. TOOL SET

A tool for all applications for trimmer adjustments. Set includes square tips, hex tips, different size screwdriver blades and recessed blades. Manufactured with tough celcon material.

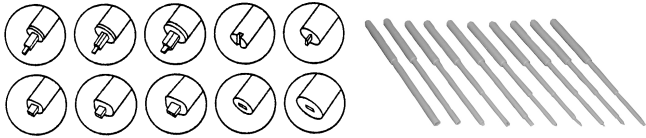

No. 63-910

10 PIECE ELECTRONIC COMBINATION WRENCH SET

This fine quality set of 10 combination wrenches is excellent for electronic repair and service. The size and thickness are especially suited for technician needs. The wrenches are the following sizes: 5/32", 3/16", 1/4", 7/32", 15/64", 5/16", 9/32", 3/8", 11/32", and 7/16". All are hot forged and chrome plated.



No. 63-608

ALIGNMENT TOOLS

MINIATURE POTENTIOMETER, "TRIMPOT" TOOL

One end is a recessed blade for non-slip adjustment of miniature potentiometers that have a protruding adjustment screw. The other end has a protruding metal blade for pots with flush screw-slot adjustment. Small steel tips have negligible flux-effect: body is molded of anti-static plastic. Replaces types 8608, AS8608.

No. 63-8608

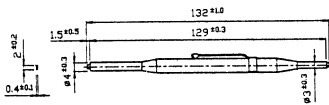

DOUBLE HEX ALIGNMENT TOOL

A broad usage tool with stepped .078" hex and 0.10" hex on one end, preceded by a fine .020" x .065" flat blade. The opposite end is a 0.10" hex preceded by a .030" x .10" flat blade. Overall length is 7-9/16", molded of durable Nylon.

No. 63-9297

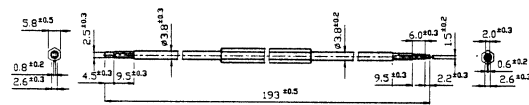

SQUARE and HEX ALIGNMENT TOOL

Square: .060" Hex: 0.10"

A double-ended, anti-static alignment tool for ferrite core transformers. One end is a square .060" tip with an additional protruding flat (.024" thick) blade. The other end is a 0.10" hex with a protruding (.039" thick) blade. Replaces types 9440 and AS9440.

No. 63-9440

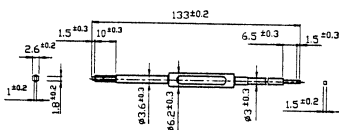

LONG REACH ALIGNER, WITH HANDLE

A plastic alignment tool with a 0.02" x .080" steel tip. Length of shaft from tip to handle is 5-3/4". overall tool length is 7-7/8". Shaft is somewhat flexible for tight spots; handle provides better grip than regular alignment tools.

No. 63-5001

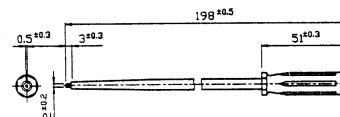

STEEL TIP DUAL ALIGNMENT TOOL

Recessed steel tip one end, protruding steel tip on the other. Tool shaft dia. 7/32" (5.5mm). The recessed tip fits a no.6 slotted shaft common to many I.F. transformers. The protruding tip is .130" wide and protrudes .190". Molded of anti-static material. Replaces types 8276 and AS8276.

No. 63-8276

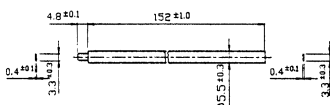

DOUBLE 078 HEX ALIGNER HEX: .078"

A Nylon tool .078" hex on both ends; one end undercut for reaching through to a bottom slug, the other with a stop to prevent over-reaching. Replaces type 9300.

No. 63-9300

